



nanni

MARINE
ACCESSORIES
2024-2025

SUMMARY

1
FUEL CIRCUIT



2
CONTROLS AND CABLES



3
EXHAUST



4
PROPULSION



5
SEA WATER CIRCUIT



6
ELECTRICITY



7
PUMPS



8
MAINTENANCE



1 • FUEL CIRCUIT



Water/Gasoline separator filters Marine engines out-board & in-board

| PETROL SEPARATORS FILTERS | | | Reference |
|---------------------------|------------------------------|------------------|------------|
| ◆ | 95 l/h - 10μ - 1/4" 18 NPTF | Transparent bowl | QFI00025GR |
| ◆ | 227 l/h - 10μ - 1/4" 18 NPTF | Transparent bowl | QFI00320GR |
| ◆ | 340 l/h - 10μ - 3/8" 18 NPTF | Transparent bowl | QFI00660GR |



Separators filters water-Diesel 57-170 l/h

| DIESEL FILTERS (Spin-On) | | | Reference |
|--------------------------|------------------------------|------------------|------------|
| ◆ | 57 l/h - 30μ - 1/4" 18 | Transparent bowl | QFI00120GR |
| ◆ | 114 l/h - 10μ - 1/4" 18 NPTF | Transparent bowl | QFI00230GR |
| ◆ | 170 l/h - 10μ - 1/4" 18 NPTF | Transparent bowl | QFI00245GR |



Filter cartridges replacement Engines Gasoline & Diesel

| PETROL CARTRIDGES | | | Reference |
|-------------------|--------------------------|---------------------------------|------------|
| ◆ | Microbloc™ 10μ cartridge | For filter ref QFI00025GR (95) | QRE00095GR |
| ◆ | Microbloc™ 10μ cartridge | For filter ref QFI00320GR (227) | QRE10321GR |
| ◆ | Microbloc™ 10μ cartridge | For filter ref QFI00660GR (340) | QRE10660GR |

| DIESEL CARTRIDGE | | | Reference |
|------------------|--------------------------|---------------------------|------------|
| ◆ | Microbloc™ 30μ cartridge | For filter ref QFI00120GR | QRE30120GR |
| ◆ | Microbloc™ 30μ cartridge | For filter ref QFI00230GR | QRE30230GR |
| ◆ | Microbloc™ 30μ cartridge | For filter ref QFI00245GR | QRE30245GR |



Connectors

| CONNECTORS 1/4"-18 NPTF FOR SPIN-ON FILTERS "G" & "GP" | | Reference |
|--|---|------------|
| | ◆ Elbow connector 90° 1/4"-18 NPTF for 6 mm inner hose | QCT00034GR |
| | ◆ Elbow connector 90° 1/4"-18 NPTF for 8 mm inner hose | QCT00001GR |
| | ◆ Elbow connector 90° 1/4"-18 NPTF for 10 mm inner hose | QCT00003GR |
| | ◆ Straight connector 1/4"-18 NPTF for 6 mm inner hose | QCT00012GR |
| | ◆ Straight connector 1/4"-18 NPTF for 8 mm inner hose | QCT00002GR |
| | ◆ Straight connector 1/4"-18 NPTF for 10 mm inner hose | QCT00005GR |
| CONNECTORS 3/8"-18 NPTF FOR SPIN-ON FILTERS "G" & "GP" | | Reference |
| | ◆ Straight connector 3/8"-18 NPTF for 8 mm inner hose | QCT00008GR |
| | ◆ Straight connector 3/8"-18 NPTF for 10 mm inner hose | QCT00010GR |
| | ◆ Elbow connector 90° 3/8"-18 NPTF for 8 mm inner hose | QCT00035GR |
| | ◆ Elbow connector 90° 3/8"-18 NPTF for 10 mm inner hose | QCT00036GR |



Separators filters water-Diesel 227 to 454 lh Serie 500



| TURBINE SERIES DIESEL SEPARATOR FILTERS 227 l/h | | Référence |
|---|------------------------|------------|
| ◆ 227 l/h - 30μ - 3/4"-16 UNF | Transparent bowl | QFI00500GR |
| ◆ 227 l/h - 30μ - 3/4"-16 UNF | Flame retardant baffle | QFI00510GR |
| ◆ 227 l/h - 30μ - 3/4"-16 UNF | Metal bowl | QFI00520GR |
| ◆ 227 l/h - 30μ - 3/4"-16 UNF | 100 % stainless steel | QFI00530GR |





| DOUBLE PERMUTABLE SEPARATOR FILTERS 227-454 l/h | | Reference |
|---|------------------------|------------|
| ◆ 227-454 l/h - 30μ - 7/8"-14 UNF | Transparent bowl | QFI75500GR |
| ◆ 227-454 l/h - 30μ - 7/8"-14 UNF | Flame retardant baffle | QFI75510GR |
| ◆ 227-454 l/h - 30μ - 7/8"-14 UNF | Metal bowl | QFI75520GR |
| ◆ 227-454 l/h - 30μ - 7/8"-14 UNF | 100 % stainless steel | QFI75530GR |

Filter cartridges replacement

| TURBINE FILTER REPLACEMENT CARTRIDGES 227-454 l/h | Reference |
|---|------------|
| ◆ Microbloc™ 2μ cartridge | QRE00502GR |
| ◆ Microbloc™ 10μ cartridge | QRE00510GR |
| ◆ Microbloc™ 30μ cartridge | QRE00530GR |



Connectors

| CONNECTORS 3/4"-16 UNF FOR SPIN-ON FILTERS "GTB228" & "GTB455" | | Reference |
|---|--|------------|
|  | ◆ Elbow connector 90° 3/4"-16 UNF for 8 mm inner hose | QCT00004GR |
| | ◆ Elbow connector 90° 3/4"-16 UNF for 10 mm inner hose | QCT00011GR |
| | ◆ Elbow connector 90° 3/4"-16 UNF for 12 mm inner hose | QCT00009GR |
|  | ◆ Straight connector 3/4"-16 UNF for 8 mm inner hose | QCT00037GR |
| | ◆ Straight connector 3/4"-16 UNF for 10 mm inner hose | QCT00007GR |
| | ◆ Straight connector 3/4"-16 UNF for 12 mm inner hose | QCT00006GR |



Separators filters water-Diesel 341 to 681 lh Serie 900



| TURBINE SERIES DIESEL SEPARATOR FILTERS 341 l/h | | Reference |
|---|------------------------|------------|
| ◆ 341 l/h - 30μ - 7/8"-16 UNF | Transparent bowl | QFI00900GR |
| ◆ 341 l/h - 30μ - 7/8"-16 UNF | Flame retardant baffle | QFI00910GR |
| ◆ 341 l/h - 30μ - 7/8"-16 UNF | Metal bowl | QFI00920GR |
| ◆ 341 l/h - 30μ - 7/8"-16 UNF | 100 % Stainless steel | QFI00930GR |





| DOUBLE PERMUTABLE SEPARATOR FILTERS 341-681 l/h | | Reference |
|---|------------------------|------------|
| ◆ 341-681 l/h - 30μ - 7/8"-14 UNF | Transparent bowl | QFI75900GR |
| ◆ 341-681 l/h - 30μ - 7/8"-14 UNF | Flame retardant baffle | QFI75910GR |
| ◆ 341-681 l/h - 30μ - 7/8"-14 UNF | Metal bowl | QFI75920GR |
| ◆ 341-681 l/h - 30μ - 7/8"-14 UNF | 100 % Stainless steel | QFI75930GR |

Filter cartridges replacement

| TURBINE FILTER REPLACEMENT CARTRIDGES 341-681 l/h | Reference |
|---|------------|
| ◆ Microbloc™ 2μ cartridge | QRE00902GR |
| ◆ Microbloc™ 10μ cartridge | QRE00910GR |
| ◆ Microbloc™ 30μ cartridge | QRE00930GR |



Connectors

| CONNECTORS 7/8"-14 UNF FOR TURBINE FILTERS "GTB341" & "GTB681" | | Reference |
|---|--|------------|
|  | ◆ Elbow connector 90° 7/8"-14 UNF for 10 mm inner hose | QCT00013GR |
| | ◆ Elbow connector 90° 7/8"-14 UNF for 12 mm inner hose | QCT00014GR |
|  | ◆ Straight connector 7/8"-14 UNF for 10 mm inner hose | QCT00015GR |
| | ◆ Straight connector 7/8"-14 UNF for 12 mm inner hose | QCT00016GR |



Separators filters water-Diesel 455 to 910 lh Serie 455



| TURBINE SERIES DIESEL SEPARATOR FILTERS 455 l/h | | Reference |
|---|------------------------|------------|
| ◆ 455 l/h - 30μ - 3/4"-16 UNF | Transparent bowl | QFI45510GR |
| ◆ 455 l/h - 30μ - 3/4"-16 UNF | Flame retardant baffle | QFI45520GR |
| ◆ 455 l/h - 30μ - 3/4"-16 UNF | Metal bowl | QFI45530GR |
| ◆ 455 l/h - 30μ - 3/4"-16 UNF | 100 % stainless steel | QFI45540GR |





| DOUBLE PERMUTABLE SEPARATOR FILTERS 455-910 l/h | | Reference |
|---|------------------------|------------|
| ◆ 455-910 l/h - 30μ - 7/8"-14 UNF | Transparent bowl | QFI45550GR |
| ◆ 455-910 l/h - 30μ - 7/8"-14 UNF | Flame retardant baffle | QFI45560GR |
| ◆ 455-910 l/h - 30μ - 7/8"-14 UNF | Metal bowl | QFI45570GR |
| ◆ 455-910 l/h - 30μ - 7/8"-14 UNF | 100 % stainless steel | QFI45580GR |

Filter cartridges replacement

| TURBINE FILTER REPLACEMENT CARTRIDGES 455-910 l/h | Reference |
|---|------------|
| ◆ Microbloc™ 2μ cartridge | QRE45502GR |
| ◆ Microbloc™ 10μ cartridge | QRE45510GR |
| ◆ Microbloc™ 30μ cartridge | QRE45530GR |



Connectors

| CONNECTORS 3/4"-16 UNF FOR TURBINE FILTERS "GTB228" & "GTB455" | | Reference |
|--|--|------------|
|  | ◆ Elbow connector 90° 3/4"-16 UNF for 8 mm inner hose | QCT00004GR |
| | ◆ Elbow connector 90° 3/4"-16 UNF for 10 mm inner hose | QTC00011GR |
| | ◆ Elbow connector 90° 3/4"-16 UNF for 12 mm inner hose | QCT00009GR |
|  | ◆ Straight connector 3/4"-16 UNF for 10 mm inner hose | QCT00007GR |
| | ◆ Straight connector 3/4"-16 UNF for 12 mm inner hose | QCT00006GR |



Separators filters water-Diesel 681 à 1363 lh Serie 1000



| TURBINE SERIES DIESEL SEPARATOR FILTERS 681 l/h | | Reference |
|---|------------------------|------------|
| ◆ 681 l/h - 30µ - 7/8"-16 UNF | Transparent bowl | QFI01000GR |
| ◆ 681 l/h - 30µ - 7/8"-16 UNF | Flame retardant baffle | QFI01010GR |
| ◆ 681 l/h - 30µ - 7/8"-16 UNF | Metal bowl | QFI01020GR |
| ◆ 681 l/h - 30µ - 7/8"-16 UNF | 100 % stainless steel | QFI01030GR |





| DOUBLE PERMUTABLE SEPARATOR FILTERS 681-1363 l/h | | Reference |
|--|------------------------|------------|
| ◆ 681-1363 l/h - 30µ - 7/8"-14 UNF | Tansparent bowl | QFI75100GR |
| ◆ 681-1363 l/h - 30µ - 7/8"-14 UNF | Flame retardant baffle | QFI75110GR |
| ◆ 681-1363 l/h - 30µ - 7/8"-14 UNF | Metal bowl | QFI75120GR |
| ◆ 681-1363 l/h - 30µ - 7/8"-14 UNF | 100 % stainless steel | QFI75130GR |

Filter cartridges replacement

| TURBINE FILTER REPLACEMENT CARTRIDGES 681-1363 l/h | Reference |
|--|------------|
| ◆ Microbloc™ 2µ cartridge | QRE01002GR |
| ◆ Microbloc™ 10µ cartridge | QRE01010GR |
| ◆ Microbloc™ 30µ cartridge | QRE01030GR |



Connectors

| CONNECTORS 7/8"-14 UNF FOR TURBINE FILTERS "GTB341" & "GTB681" | | Reference |
|---|--|------------|
|  | ◆ Elbow connector 90° 7/8"-14 UNF for 10 mm inner hose | QCT00013GR |
| | ◆ Elbow connector 90° 7/8"-14 UNF for 12 mm inner hose | QCT00014GR |
| | ◆ Elbow connector 90° 7/8»-14 UNF for 16 mm inner hose | QCT00038GR |
|  | ◆ Straight connector 7/8"-14 UNF for 10 mm inner hose | QCT00015GR |
| | ◆ Straight connector 7/8"-14 UNF for 12 mm inner hose | QCT00016GR |
| | ◆ Straight connector 7/8»-14 UNF for 16 mm inner hose | QCT00039GR |



Separators filters water-Diesel 1363 to 2044 lh



| TRIPLE PERMUTABLE SEPARATOR FILTERS 1363-2044 l/h | Reference |
|---|------------|
| ◆ 681-1363 l/h - 30μ - 7/8"-14 UNF Transparent bowl | QFI71000GR |
| ◆ 681-1363 l/h - 30μ - 7/8"-14 UNF Flame retardant baffle | QFI71010GR |
| ◆ 681-1363 l/h - 30μ - 7/8"-14 UNF Metal bowl | QFI71020GR |
| ◆ 681-1363 l/h - 30μ - 7/8"-14 UNF 100 % stainless steel | QFI71030GR |

Filter cartridges replacement

| TRIPLES & PERMUTABLES REPLACEMENT CARTRIDGE FILTERS 1363-2044 l/h | Reference |
|---|------------|
| ◆ Microbloc™ 2μ cartridge | QRE01002GR |
| ◆ Microbloc™ 10μ cartridge | QRE01010GR |
| ◆ Microbloc™ 30μ cartridge | QRE01030GR |



WATER-FUEL SEPARATOR FILTERS

DIESEL FLOW ESTIMATION

The ratio is given in liters per hour (LPH). It is equal to the power (CV) multiplied by 18% ($LPH = CV \times 0.18 \times 3.785$).

ESTIMATION OF GASOLINE FLOW

The ratio is given in liters per hour (LPH). It is equal to the power (CV) multiplied by 10% ($LPH = CV \times 0.1 \times 3.785$).

1 Liter per hour (LPH) = 0.264 Gallons per hour (GPH).

250 & 300 l/h water-diesel separator filters



| DIESEL SEPARATOR FILTER 250 l/h | Reference |
|---------------------------------|------------|
| ◆ Prefilter decanter D8 | QFI00870AK |
| ◆ Cartridge | 48100780B |
| ◆ Metallic plug | 43003000 |



| DIESEL SEPARATOR FILTERL 300 l/h | Reference |
|----------------------------------|------------|
| ◆ Prefilter decanter GRE 300 | QFI00300VX |

Hoses

HYDROCARBON HOSES ISO 7840 A1.

Black NBR tube reinforced with a synthetic fabric, smooth appearance withstanding liquids from -20° to +80°C.

| | Reference |
|-----------|------------|
| ◆ Ø 5 mm | 32805001 |
| ◆ Ø 6 mm | 32806002 |
| ◆ Ø 8 mm | 32808002 |
| ◆ Ø 10 mm | 32810002 |
| ◆ Ø 13 mm | 32813001 |
| ◆ Ø 16 mm | QTC00016NI |



Accessories

| ACCESSORIES FOR TURBINE FILTER SEPARATORS | Reference |
|---|-----------|
| ◆ Water presence and alarm kit 12/24 Volts | 48202625 |
| ◆ T «Handle» clogging gauge (included on Double swappable models) | 48202626 |



2 • CONTROLS & CABLES



AVENTICS by NANNI

MAREX 3D

Easy to operate

How to maneuver a yacht using up to 4 propulsion systems simultaneously.

- Starboard engine
- Portside engine
- Bow thruster
- Stern thruster



MAREX OS 3D

Easy to operate

The Marex 3D Joystick system is designed to facilitate maneuvering the easiest way.

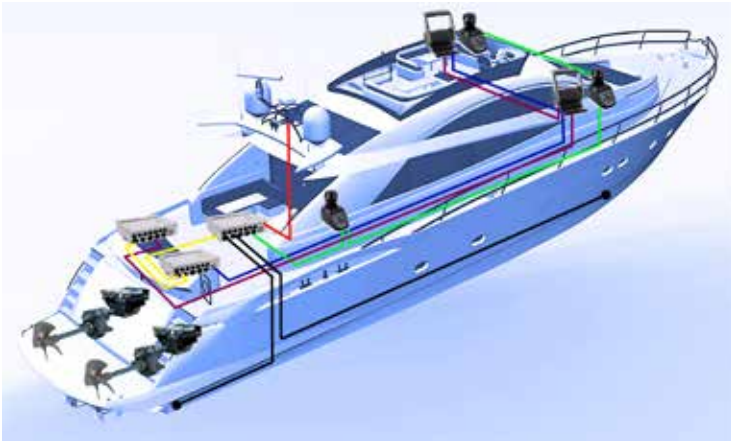

MAREX ECS 3D

Easy to operate

Self-correction thanks to the optional compass function. The Marex 3D Joystick system is designed to facilitate maneuvering the easiest way.

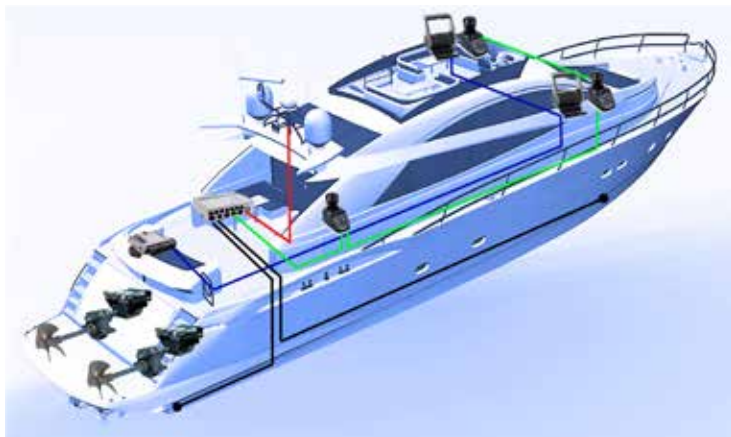

AVENTICS by NANNI

MAREX OS 3D

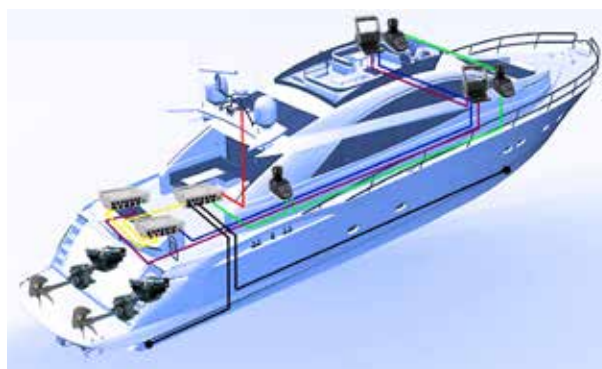

| Marex OS 3D | Reference |
|-----------------------------------|-----------|
| ◆ Joystick type 351 chrome plated | 644363 |
| ◆ Control Unit MPC OS 3D | 644322 |

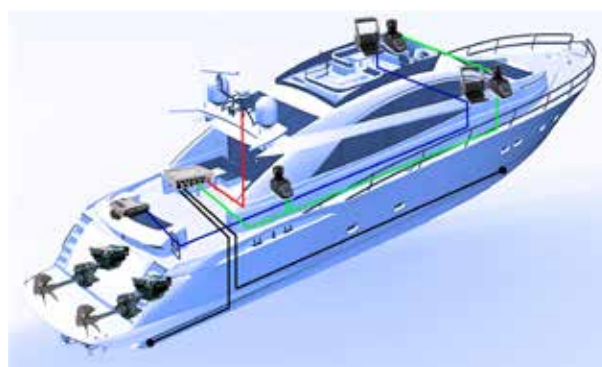

◆ Single Control head
Reference : 644381

◆ Twin Control head
Reference : 644383



◆ Actuator 12 V or 24 V
Reference : 644387 12 V
Reference : 644388 24 V

◆ Calculator
Reference : 644384

Single lever, dual function control boxes



700SS/SM

Uses 2 x 33C, Mercury cables.
Acceleration only by pressing the button.

| FLUSH-MOUNTED SIDE BOX | Reference |
|-----------------------------------|------------|
| ◆ Sail boat design | QCM00103TF |
| ◆ Standard | QCM00105TF |
| ◆ With Trim and neutral interlock | QCM00133TF |
| ◆ With Trolling Valve | QCM00227TF |



CH285

Uses 2 33C cables.
Acceleration only by pressing on the button.
With G/P control on request.

| FLUSH-MOUNTED SIDE BOX | Reference |
|------------------------|------------|
| ◆ Standard | QCM00285TF |



Xtreme Side Mount

Uses 2 cables 33C, Mercury, OMC.
Acceleration only by pressing button.
Neutral starting safety.

| FLUSH-MOUNTED SIDE BOX | Reference |
|--|-------------------|
| ◆ Standard | Chrome QCM00010TF |
| ◆ With Trim | Chrome QCM00011TF |
| ◆ With Trim &Tilt switch | Chrome QCM00012TF |
| ◆ Standard | Black QCM00003TF |
| ◆ With Trim switch & neutral interlock | Black QCM00004TF |
| ◆ Connection kit | QCM00001TF |
| ◆ Neutral start safety | QCM00002TF |



700TS

Uses 2 x 33C, Mercury cables.
Acceleration only by pressing the button.

| FLUSH-MOUNTED DESK BOX | Reference |
|------------------------|------------|
| ◆ Standard | QCM00107TF |
| ◆ With Trim | QCM00135TF |



Xtreme Top Mount

Uses 2 cables 33C, Mercury, OMC.
Acceleration only by pressing button.
Neutral starting safety.

| FLUSH-MOUNTED SIDE BOX | Reference |
|------------------------|-------------------|
| ◆ Standard | Chrome QCM00013TF |
| ◆ With Trim switch | Chrome QCM00014TF |
| ◆ Standard | Black QCM00005TF |
| ◆ With Trim switch | Black QCM00006TF |
| ◆ Connection kit | QCM00001TF |
| ◆ Neutral start safety | QCM00002TF |

Universal control for all engines outboard, sterndrive and inboard engines.

Features:

- Compatible with all types of control cables 33C control cables and engine specific cables: Mercury, Yamaha, BRP, Suzuki, Honda, Tohatsu in OMC/Johnson/Evinrude (≥ 1979),
- Optional adjustment switch,
- Tilt switch option,
- Throttle warm-up in neutral,
- Neutral Lock,
- Neutral safety switch (protection against starting in gear),
- Emergency stop switch,
- Adjustable friction,
- Chrome finish.

Single lever, dual function control boxes



MT3

Uses 2 cables 33C.
 Uses 2 cables 43C with kit QCC43008TF.
 Neutral start safety.

| FLUSH-MOUNTED DESK BOX | Reference |
|------------------------|------------|
| ◆ Standard | QCM00731TF |

Single lever, single function control boxes



STB

Uses a 33C cable.
 To use a 43C, add a QCC43004TF kit.
 Can command a Trolling Valve.

| FLUSH-MOUNTED SIDE BOX | Reference |
|------------------------|------------|
| ◆ With brake | QCM00777TF |



NB

Uses 33C or 43C cable.
 Locking of the gas lever by turning the handle.
 3 positions locking for reverser.

| FLUSH-MOUNTED DESK BOX | Reference |
|------------------------|------------|
| ◆ Gas lever | QCM00028TF |
| ◆ Reversing lever | QCM00102TF |



S

Uses 33C or 43C cable.
 3 position detent.
 Built-in brake.

| FLUSH-MOUNTED DESK BOX | Reference |
|------------------------|------------|
| ◆ Single box | QCM31002TF |

Dual lever, dual function control boxes



MT5

Uses 2 cables 33C.
Uses 2 cables 43C with kit QCC43008TF.
Acceleration only by releasing the lever.
Neutral start safety.

| FLUSH-MOUNTED DESK BOX | Reference |
|------------------------|------------|
| ◆ Standard | QCM00732TF |



Xtreme Dual Top Mount

Uses 4 cables 33C, Mercury, OMC.
Acceleration only by pressing button.
Neutral starting safety.

| FLUSH-MOUNTED DESK BOX | Reference |
|--------------------------|-------------------|
| ◆ Standard | Chrome QCM00015TF |
| ◆ With Trim switch | Chrome QCM00016TF |
| ◆ Standard | Black QCM00007TF |
| ◆ With Trim switch | Black QCM00008TF |
| ◆ With Trim &Tilt switch | Black QCM00009TF |
| ◆ Connection kit | QCM00001TF |
| ◆ Neutral start safety | QCM00002TF |



700TD

Bi-function. Uses 4 33C cables.
Acceleration only by pressing on the button.

| FLUSH-MOUNTED DESK BOX | Reference |
|------------------------|------------|
| ◆ Standard | QCM00109TF |
| ◆ With Trim | QCM00149TF |

Double lever, single function control box



NBT

Uses 2 cables 33C or 43C.
Locking of the gas lever by turning the of the lever.
3 positions locking for reverser.

| FLUSH-MOUNTED DESK BOX | Reference |
|------------------------|------------|
| ◆ Dual lever gas/inv | QCM00029TF |



S

Uses 2 cables 33C or 43C.
3 position crimping.
Built-in brake.

| FLUSH-MOUNTED DESK BOX | Reference |
|------------------------|------------|
| ◆ Double box | QCM31001TF |

Differential controls for 2 stations



33C or 43C cable.
One per engine.

| DIFFERENTIAL CONTROL | Reference |
|------------------------|------------|
| ◆ Reverse differential | QCM00573TF |

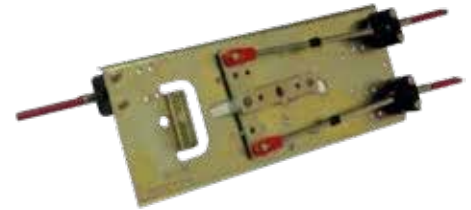

33C or 43C cable.
One per engine.

| DIFFERENTIAL CONTROL | Reference |
|-----------------------------|------------|
| ◆ Acceleration differential | QCM00572TF |



Uses 2 cables 33C or 43C.
Allows the locking of the differential of the reverser.

| DIFFERENTIAL CONTROL | Reference |
|----------------------|------------|
| ◆ Remote selector | QCM00993TF |



For double cockpit.

| DIFFERENTIAL CONTROL | Reference |
|-------------------------|------------|
| ◆ Dual control throttle | QCM00060VT |

33C Cables



*Stainless steel end cap and cable for heavy use.
From 0,75 to 10 m: every 25 cm.
From 10 to 15 m: every 50 cm.
Beyond: every meter.
Symmetrical cables at the ends. 76 mm stroke.*

33C

| Length feet | Length meters | Reference |
|-------------|---------------|------------|
| ◆ 3 | ◆ 0,92 m | QCA33003ST |
| ◆ 4 | ◆ 1,22 m | QCA33004ST |
| ◆ 5 | ◆ 1,52 m | QCA33005ST |
| ◆ 6 | ◆ 1,83 m | QCA33006ST |
| ◆ 7 | ◆ 2,13 m | QCA33007ST |
| ◆ 8 | ◆ 2,44 m | QCA33008ST |
| ◆ 9 | ◆ 2,74 m | QCA33009ST |
| ◆ 10 | ◆ 3,05 m | QCA33010ST |
| ◆ 11 | ◆ 3,36 m | QCA33011ST |
| ◆ 12 | ◆ 3,66 m | QCA33012ST |
| ◆ 13 | ◆ 3,96 m | QCA33013ST |

33C Xtreme

| Length feet | Length meters | Reference |
|-------------|---------------|------------|
| ◆ 14 | ◆ 4,27 m | QCA33014ST |
| ◆ 15 | ◆ 4,57 m | QCA33015ST |
| ◆ 16 | ◆ 4,88 m | QCA33016ST |
| ◆ 17 | ◆ 5,18 m | QCA33017ST |
| ◆ 18 | ◆ 5,49 m | QCA33018ST |
| ◆ 19 | ◆ 5,79 m | QCA33019ST |
| ◆ 20 | ◆ 6,1 m | QCA33020ST |
| ◆ 21 | ◆ 6,4 m | QCA33021ST |
| ◆ 22 | ◆ 6,71 m | QCA33022ST |
| ◆ 23 | ◆ 7,01 m | QCA33023ST |
| ◆ 24 | ◆ 7,32 m | QCA33024ST |
| ◆ 25 | ◆ 7,63 m | QCA33025ST |
| ◆ 26 | ◆ 7,92 m | QCA33026ST |
| ◆ 27 | ◆ 8,23 m | QCA33027ST |
| ◆ 28 | ◆ 8,53 m | QCA33028ST |
| ◆ 29 | ◆ 8,85 m | QCA33029ST |
| ◆ 30 | ◆ 9,15 m | QCA33030ST |
| ◆ 32 | ◆ 9,75 m | QCA33032ST |
| ◆ 34 | ◆ 10,36 m | QCA33034ST |
| ◆ 36 | ◆ 10,97 m | QCA33036ST |
| ◆ 38 | ◆ 11,58 m | QCA33038ST |
| ◆ 40 | ◆ 12,19 m | QCA33040ST |

For 33C cables longer than 40 feet,
see 63C cables, page 22

43C Cables



From 1.50 to 6.50 m: every 25 cm.
 From 6,50 to 10 m: every 50 cm.
 Beyond: every meter.

| Length feet | Length meters | Reference |
|-------------|---------------|------------|
| ◆ 5 | ◆ 1,52 m | QCX43005ST |
| ◆ 6 | ◆ 1,83 m | QCX43006ST |
| ◆ 7 | ◆ 2,13 m | QCX43007ST |
| ◆ 8 | ◆ 2,44 m | QCX43008ST |
| ◆ 9 | ◆ 2,74 m | QCX43009ST |
| ◆ 10 | ◆ 3,05 m | QCX43010ST |
| ◆ 11 | ◆ 3,36 m | QCX43011ST |
| ◆ 12 | ◆ 3,66 m | QCX43012ST |
| ◆ 13 | ◆ 3,96 m | QCX43013ST |
| ◆ 14 | ◆ 4,27 m | QCX43014ST |
| ◆ 15 | ◆ 4,57 m | QCX43015ST |
| ◆ 16 | ◆ 4,88 m | QCX43016ST |
| ◆ 17 | ◆ 5,18 m | QCX43017ST |
| ◆ 18 | ◆ 5,49 m | QCX43018ST |
| ◆ 19 | ◆ 5,79 m | QCX43019ST |
| ◆ 20 | ◆ 6,1 m | QCX43020ST |
| ◆ 21 | ◆ 6,4 m | QCX43021ST |
| ◆ 22 | ◆ 6,71 m | QCX43022ST |
| ◆ 23 | ◆ 7,01 m | QCX43023ST |
| ◆ 24 | ◆ 7,32 m | QCX43024ST |
| ◆ 25 | ◆ 7,63 m | QCX43025ST |

| Length feet | Length meters | Reference |
|-------------|---------------|------------|
| ◆ 26 | ◆ 7,92 m | QCX43026ST |
| ◆ 27 | ◆ 8,23 m | QCX43027ST |
| ◆ 28 | ◆ 8,53 m | QCX43028ST |
| ◆ 29 | ◆ 8,85 m | QCX43029ST |
| ◆ 30 | ◆ 9,15 m | QCX43030ST |
| ◆ 32 | ◆ 9,75 m | QCX43032ST |
| ◆ 34 | ◆ 10,36 m | QCX43034ST |
| ◆ 36 | ◆ 10,97 m | QCX43036ST |
| ◆ 38 | ◆ 11,58 m | QCX43038ST |
| ◆ 40 | ◆ 12,19 m | QCX43040ST |
| ◆ 42 | ◆ 12,8 m | QCX43042ST |
| ◆ 44 | ◆ 13,41 m | QCX43044ST |
| ◆ 46 | ◆ 14,03 m | QCX43046ST |
| ◆ 48 | ◆ 14,63 m | QCX43048ST |
| ◆ 50 | ◆ 15,24 m | QCX43050ST |
| ◆ 54 | ◆ 16,46 m | QCX43054ST |
| ◆ 60 | ◆ 18,29 m | QCX43060ST |
| ◆ 62 | ◆ 18,90 m | QCX43062ST |
| ◆ 64 | ◆ 19,51 m | QCX43064ST |
| ◆ 66 | ◆ 20,12 m | QCX43066ST |
| ◆ 68 | ◆ 20,73 m | QCX43068ST |
| ◆ 70 | ◆ 21,34 m | QCX43070ST |
| ◆ 82 | ◆ 25,00 m | QCX43082ST |
| ◆ 96 | ◆ 29,27 m | QCX43096ST |

63C Xtreme cables



| Length feet | Length meters | Reference |
|-------------|---------------|------------|
| ◆ 4 | ◆ 1,22 m | QCX63004ST |
| ◆ 5 | ◆ 1,52 m | QCX63005ST |
| ◆ 6 | ◆ 1,83 m | QCX63006ST |
| ◆ 7 | ◆ 2,13 m | QCX63007ST |
| ◆ 8 | ◆ 2,44 m | QCX63008ST |
| ◆ 9 | ◆ 2,74 m | QCX63009ST |
| ◆ 10 | ◆ 3,05 m | QCX63010ST |
| ◆ 11 | ◆ 3,36 m | QCX63011ST |
| ◆ 12 | ◆ 3,66 m | QCX63012ST |
| ◆ 13 | ◆ 3,96 m | QCX63013ST |
| ◆ 14 | ◆ 4,27 m | QCX63014ST |
| ◆ 15 | ◆ 4,57 m | QCX63015ST |
| ◆ 16 | ◆ 4,88 m | QCX63016ST |
| ◆ 17 | ◆ 5,18 m | QCX63017ST |
| ◆ 18 | ◆ 5,49 m | QCX63018ST |
| ◆ 19 | ◆ 5,79 m | QCX63019ST |
| ◆ 20 | ◆ 6,1 m | QCX63020ST |
| ◆ 21 | ◆ 6,4 m | QCX63021ST |
| ◆ 22 | ◆ 6,71 m | QCX63022ST |
| ◆ 23 | ◆ 7,01 m | QCX63023ST |
| ◆ 24 | ◆ 7,32 m | QCX63024ST |
| ◆ 25 | ◆ 7,63 m | QCX63025ST |

| Length feet | Length meters | Reference |
|-------------|---------------|------------|
| ◆ 26 | ◆ 7,92 m | QCX63026ST |
| ◆ 27 | ◆ 8,23 m | QCX63027ST |
| ◆ 28 | ◆ 8,53 m | QCX63028ST |
| ◆ 29 | ◆ 8,85 m | QCX63029ST |
| ◆ 30 | ◆ 9,15 m | QCX63030ST |
| ◆ 32 | ◆ 9,75 m | QCX63032ST |
| ◆ 34 | ◆ 10,36 m | QCX63034ST |
| ◆ 36 | ◆ 10,97 m | QCX63036ST |
| ◆ 38 | ◆ 11,58 m | QCX63038ST |
| ◆ 40 | ◆ 12,19 m | QCX63040ST |
| ◆ 42 | ◆ 12,8 m | QCX63042ST |
| ◆ 44 | ◆ 13,41 m | QCX63044ST |
| ◆ 46 | ◆ 14,03 m | QCX63046ST |
| ◆ 48 | ◆ 14,63 m | QCX63048ST |
| ◆ 50 | ◆ 15,24 m | QCX63050ST |
| ◆ 54 | ◆ 16,46 m | QCX63054ST |
| ◆ 60 | ◆ 18,29 m | QCX63060ST |
| ◆ 62 | ◆ 18,90 m | QCX63062ST |
| ◆ 64 | ◆ 19,51 m | QCX63064ST |
| ◆ 66 | ◆ 20,12 m | QCX63066ST |
| ◆ 68 | ◆ 20,73 m | QCX63068ST |
| ◆ 70 | ◆ 21,35 m | QCX63070ST |
| ◆ 72 | ◆ 21,95 m | QCX63082ST |

Stop cables

| Tab length | Reference |
|------------|------------|
| ◆ 1,52 m | QCS00002TF |
| ◆ 3,05 m | QCS00003TF |
| ◆ 4,57 m | QCS00004TF |
| ◆ 6,10 m | QCS00006TF |
| ◆ 7,62 m | QCS00007TF |
| ◆ 9,14 m | QCS00009TF |
| ◆ 10,8 m | QCS00010TF |
| ◆ 12,19 m | QCS00012TF |

Can be mounted on DC bracket.



Cable accessories



| Heads | Reference |
|-------------------|------------|
| ◆ Small model 33C | QCC33001TF |
| ◆ Large model 33C | QCC33002TF |
| ◆ Cable head 43C | QCC43001TF |



| Pivots | Reference |
|-----------------|------------|
| ◆ For cable 33C | QCC33005TF |
| ◆ Long for 33C | QCC33006TF |
| ◆ For cable 43C | QCC43004TF |



| Collars and plates | Reference |
|-----------------------|------------|
| ◆ For cable 33C | 970316093 |
| ◆ For cable 43C | QCC33006TF |
| ◆ Counterplate 33/43C | QCC43014TF |



| Eyebolts | Reference |
|-----------------|------------|
| ◆ For cable 33C | QCC33007TF |
| ◆ For cable 43C | QCC43005TF |



| Calipers | Reference |
|------------------------|------------|
| ◆ Large modele for 33C | QCC33004TF |
| ◆ Large modele for 43C | QCC43003TF |



| Supports | Reference |
|--------------------|------------|
| ◆ For 1 cable 33C | QCC33008TF |
| ◆ For 2 cables 33C | QCC33009TF |



| Conversion kit | Reference |
|--|------------|
| ◆ Endcap C to BC 1 kit (cable 33C) or C to B (2kits) | QCC33011TF |
| ◆ Endcap C to BC 1 kit (43C cable) or C to B (2kits) | QCC43007TF |



| End tip | Reference |
|--------------------|------------|
| ◆ For cable 33/43C | QCC33013TF |



| D.C array | Reference |
|----------------|------------|
| ◆ Pull tab D.C | QCC33017TF |

| Adaptation kit | Reference |
|------------------|-----------|
| ◆ Mercruiser 33C | 970312441 |

| NANNI complete kit | Reference |
|--------------------|-----------|
| ◆ Gas + Clutch | 970311229 |

NOTES

.....

.....

.....

.....

.....

.....

.....

.....

.....

.....

.....

.....

.....

.....

.....

.....

.....

.....

.....

.....

.....

.....

.....

3 • EXHAUST

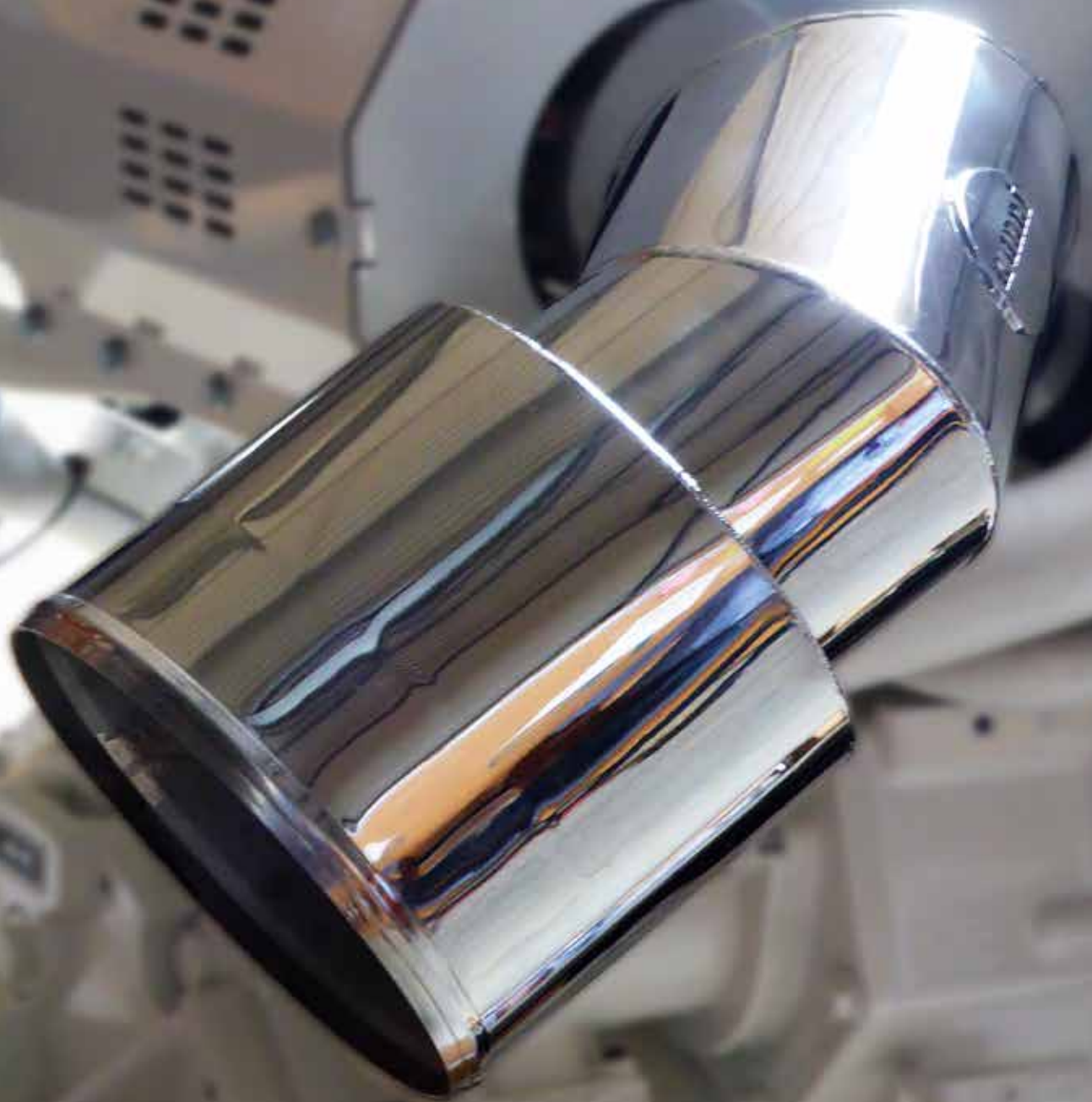

Waterlocks

| Diameter mm | Capacity | Reference |
|-------------|----------|------------|
| ◆ Ø 40 / 51 | 5 l | QWL00005NI |

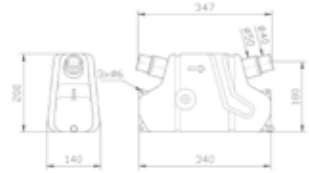

| Diameter mm | Capacity | Reference |
|------------------|----------|------------|
| ◆ Ø 50 / 60 / 75 | 8 l | QWL00008NI |

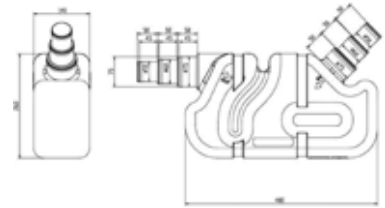

| Diameter mm | Capacity | Reference |
|-------------|----------|------------|
| ◆ Ø 60 / 80 | 15 l | QWL00015NI |

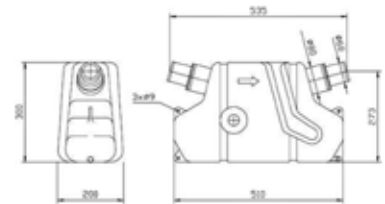

| Diameter mm | Capacity | Reference |
|--------------|----------|------------|
| ◆ Ø 90 / 104 | 20 l | QWL00020NI |

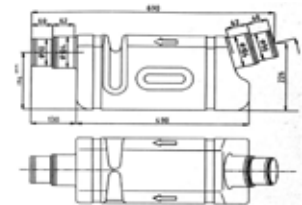

Exhaust pipes Ø 40 to 152 mm

| Diameter mm | Reference |
|-------------|------------|
| ◆ Ø 40 | QTE00040NI |
| ◆ Ø 45 | QTE00045NI |
| ◆ Ø 51 | QTE00051NI |
| ◆ Ø 54 | QTE00054NI |
| ◆ Ø 60 | QTE00060NI |
| ◆ Ø 63 | QTE00063NI |
| ◆ Ø 76 | QTE00076NI |



| Diameter mm | Reference |
|-------------|------------|
| ◆ Ø 80 | QTE00080NI |
| ◆ Ø 90 | QTE00090NI |
| ◆ Ø 102 | QTE00102NI |
| ◆ Ø 105 | QTE00105NI |
| ◆ Ø 127 | QTE00127NI |
| ◆ Ø 152 | QTE00152NI |

Syphon Breaker with valve



| Diameter mm | Reference |
|--------------|-----------|
| ◆ Ø 13 to 32 | 970301077 |

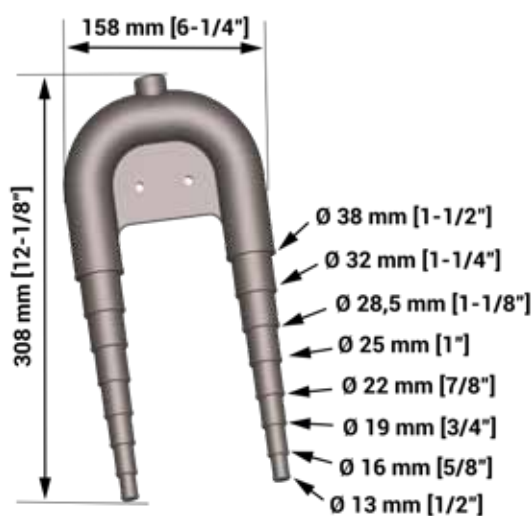

| Diameter mm | Reference |
|--------------|------------|
| ◆ Ø 13 to 38 | QCY01338AP |

Reducers

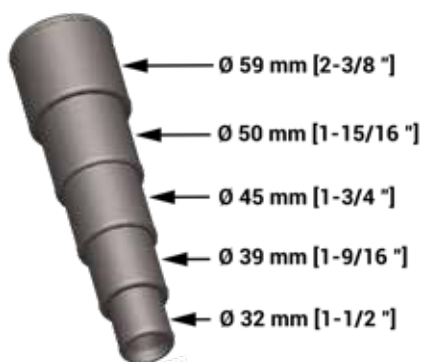

| Diameter mm | Reference |
|--------------|------------|
| ◆ Ø 30 to 60 | QFM03060AP |



| Diameter mm | Reference |
|--------------|------------|
| ◆ Ø 13 to 38 | QFM01338AP |

Plastic Mufflers

| Diameter | Reference |
|----------|------------|
| ◆ Ø 40 | QSL00040AP |
| ◆ Ø 45 | QSL00045AP |
| ◆ Ø 50 | QSL00050AP |
| ◆ Ø 60 | QSL00060AP |
| ◆ Ø 75 | QSL00075AP |
| ◆ Ø 90 | QSL00090AP |
| ◆ Ø 102 | QSL00102AP |

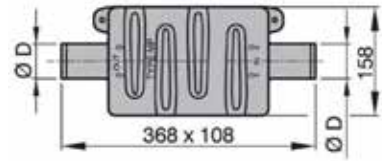

Ø 40 - Ø 75

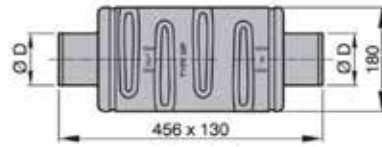

Gooseneck

| Diameter | Reference | Angle |
|------------------|------------|-------|
| ◆ Ø 40 - 45 - 50 | QCY00040AP | 180° |
| ◆ Ø 40 - 45 - 50 | QCY00045AP | 150° |
| ◆ Ø 60 | QCY00060VT | 180° |



150°

180°

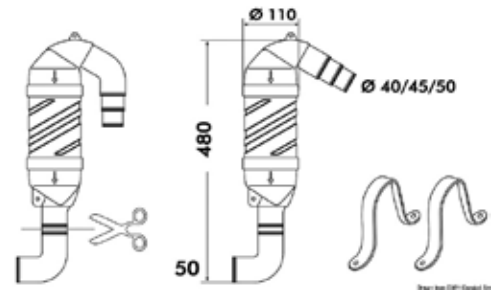

Ø 40/45/50

From the OEM Manual for

Stainless steel collars



| Trunnion collars | Reference |
|-------------------------|------------|
| ◆ Ø 48-51 Strip 18 mm | QCT04851NI |
| ◆ Ø 52-55 Strip 20 mm | QCT05255NI |
| ◆ Ø 56-59 Strip 20 mm | QCT05659NI |
| ◆ Ø 60-63 Strip 20 mm | QCT06063NI |
| ◆ Ø 64-67 Strip 20 mm | QCT06467NI |
| ◆ Ø 68-73 Strip 20 mm | QCT06873NI |
| ◆ Ø 74-79 Strip 20 mm | QCT07479NI |
| ◆ Ø 80-85 Strip 20 mm | QCT08085NI |
| ◆ Ø 86-91 Strip 20 mm | QCT08691NI |
| ◆ Ø 92-97 Strip 20 mm | QCT09297NI |
| ◆ Ø 98-103 Strip 20 mm | QCT98103NI |
| ◆ Ø 104-112 Strip 20 mm | QCT10412NI |
| ◆ Ø 113-121 Strip 25 mm | QCT11321NI |
| ◆ Ø 122-130 Strip 25 mm | QCT12230NI |
| ◆ Ø 131-139 Strip 25 mm | QCT13139NI |
| ◆ Ø 140-148 Strip 25 mm | QCT14048NI |
| ◆ Ø 149-161 Strip 25 mm | QCT14961NI |
| ◆ Ø 162-174 Strip 25 mm | QCT16274NI |
| ◆ Ø 175-187 Strip 25 mm | QCT17587NI |
| ◆ Ø 214-226 Strip 25 mm | QCT21426NI |

| Regular collars | Reference |
|-------------------------|------------|
| ◆ Ø 08-16 Strip 9 mm | QCS00816NI |
| ◆ Ø 16-27 Strip 9 mm | 970301504 |
| ◆ Ø 20-32 Strip 12 mm | 970604526 |
| ◆ Ø 25-40 Strip 12 mm | 970300922 |
| ◆ Ø 32-50 Strip 12 mm | 970604533 |
| ◆ Ø 40-60 Strip 12 mm | QCS04060NI |
| ◆ Ø 50-70 Strip 12 mm | QCS05070NI |
| ◆ Ø 60-80 Strip 12 mm | QCS06080NI |
| ◆ Ø 70-90 Strip 12 mm | QCS07090NI |
| ◆ Ø 80-100 Strip 12 mm | QCS80100NI |
| ◆ Ø 90-110 Strip 12mm | QCS90110NI |
| ◆ Ø 100-120 Strip 12 mm | QCS10012NI |
| ◆ Ø 110-130 Strip 12 mm | QCS11013NI |
| ◆ Ø 120-140 Strip 12 mm | QCS12014NI |
| ◆ Ø 130-150 Strip 12 mm | QCS13015NI |
| ◆ Ø 140-160 Strip 12 mm | QCS14016NI |
| ◆ Ø 150-170 Strip 12 mm | QCS15017NI |
| ◆ Ø 160-180 Strip 12 mm | QCS16080NI |
| ◆ Ø 170-190 Strip 12 mm | QCS17019NI |
| ◆ Ø 180-200 Strip 12 mm | QCS18020NI |
| ◆ Ø 190-210 Strip 12 mm | QCS19021NI |
| ◆ Ø 200-220 Strip 12 mm | QCS20022NI |
| ◆ Ø 210-230 Strip 12 mm | QCS21023NI |

Straight Stainless steel A316 exhaust outlets

| Ø Flange | Ø Cut-out | Ø Hose | Reference |
|----------|-----------|--------|------------|
| ◆ Ø 75 | ◆ Ø 45 | ◆ Ø 40 | QSI00040AP |
| ◆ Ø 75 | ◆ Ø 45 | ◆ Ø 45 | QSI00045AP |
| ◆ Ø 100 | ◆ Ø 60 | ◆ Ø 50 | QSI00050AP |
| ◆ Ø 100 | ◆ Ø 60 | ◆ Ø 60 | QSI00060AP |
| ◆ Ø 131 | ◆ Ø 90 | ◆ Ø 75 | QSI00075AP |
| ◆ Ø 131 | ◆ Ø 90 | ◆ Ø 90 | QSI00090AP |



Stainless steel straight exhaust outlets

316L stainless steel, 2 sides welding, TIG with stainless steel filler metal.

| Diameter | Reference |
|----------|------------|
| ◆ Ø 40 | QSI00040NI |
| ◆ Ø 45 | QSI00045NI |
| ◆ Ø 50 | QSI00050NI |
| ◆ Ø 60 | QSI00060NI |
| ◆ Ø 76 | QSI00076NI |
| ◆ Ø 80 | QSI00080NI |
| ◆ Ø 90 | QSI00090NI |
| ◆ Ø 104 | QSI00104NI |

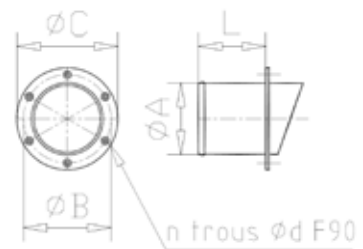

90° angled stainless steel exhaust outlets

316L stainless steel, 2 sides welding, TIG with stainless steel filler metal.

| Diameter | Reference |
|----------|------------|
| ◆ Ø 40 | QSI09040NI |
| ◆ Ø 45 | QSI09045NI |
| ◆ Ø 50 | QSI09050NI |
| ◆ Ø 60 | QSI09060NI |
| ◆ Ø 76 | QSI09076NI |
| ◆ Ø 80 | QSI09080NI |
| ◆ Ø 90 | QSI09090NI |

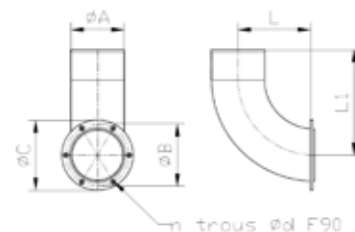

4 • PROPULSION



Propeller for shaft line

| Ø Inches | Ø mm | 2 blades type 30 Ø Inches | 3 blades type 50 Ø Inches | 3 blades type 55 Ø Inches | 4 blades type 69 to 75 Ø Inches |
|----------|------|------------------------------|------------------------------|------------------------------|------------------------------------|
| ◆ 12" | 305 | 12" | 12" | 12" | 12" |
| ◆ 13" | 330 | 13" | 13" | 13" | 13" |
| ◆ 14" | 356 | 14" | 14" | 14" | 14" |
| ◆ 15" | 381 | 15" | 15" | 15" | 15" |
| ◆ 16" | 406 | 16" | 16" | 16" | 16" |
| ◆ 17" | 432 | 17" | 17" | 17" | 17" |
| ◆ 18" | 457 | 18" | 18" | 18" | 18" |
| ◆ 19" | 483 | | 19" | 19" | 19" |
| ◆ 20" | 508 | | 20" | 20" | 20" |
| ◆ 21" | 533 | | | 21" | 21" |
| ◆ 22" | 558 | | | 22" | 22" |
| ◆ 23" | 584 | | | 23" | 23" |

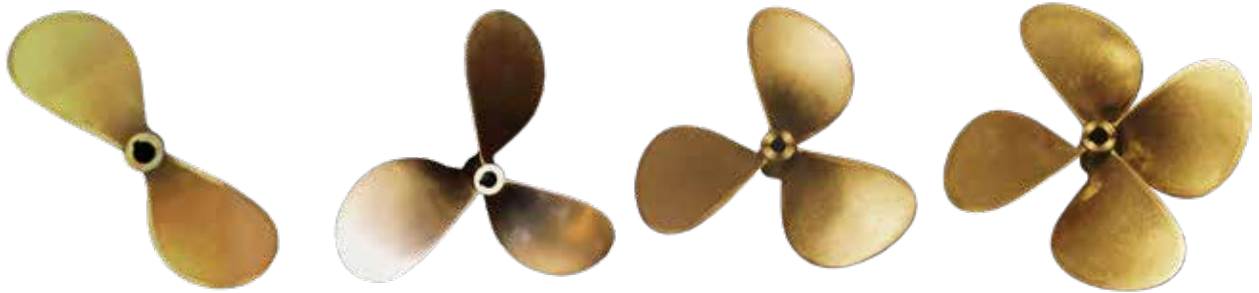

Sail Drive Aluminum 2 Blades Propeller

| Ø mm | Step | Reference |
|------|------|-----------|
| ◆ 14 | 8" | 31408S253 |
| ◆ 14 | 10" | 31410S253 |
| ◆ 14 | 11" | 31411S253 |
| ◆ 15 | 9" | 31509S253 |
| ◆ 15 | 10" | 31510S253 |
| ◆ 15 | 11" | 31511S253 |
| ◆ 15 | 12" | 31512S253 |
| ◆ 16 | 11" | 31611S253 |
| ◆ 16 | 12" | 31612S253 |
| ◆ 17 | 11" | 31711S253 |
| ◆ 17 | 13" | 31713S253 |
| ◆ 17 | 14" | 31714S253 |
| ◆ 17 | 15" | 31715S253 |



Sail Drive Aluminum 3 Blades propeller

| Ø mm | Step | Reference |
|------|------|-----------|
| ◆ 14 | 12" | 31412S313 |
| ◆ 16 | 10" | 31610S313 |
| ◆ 17 | 11" | 31711S313 |
| ◆ 17 | 12" | 31712S313 |
| ◆ 17 | 13" | 31713S313 |
| ◆ 17 | 14" | 31714S313 |
| ◆ 17 | 16" | 31715S313 |
| ◆ 17 | 17" | 31716S313 |
| ◆ 18 | 16" | 31717S313 |



Two-blades folding Sail Drive propeller

| ∅ Propeller Inches | Rotation | Step |
|--------------------------|----------|-------|
| ◆ 13 | L/R | 8-11 |
| ◆ 14 | L/R | 9-12 |
| ◆ 15 | L/R | 9-13 |
| ◆ 16 | L/R | 10-14 |
| ◆ 17 | L/R | 11-15 |
| ◆ 18 | L/R | 12-16 |
| ◆ 19 | L/R | 12-17 |
| ◆ 20 | L/R | 14-18 |

 **flexofold**
sailboat propellers



Step available from 1 to 1 in RH or LH.

Three-blades folding Sail Drive propeller

| ∅ Propeller Inches | Rotation | Step |
|--------------------------|----------|-------|
| ◆ 14 | L/R | 8-12 |
| ◆ 15 | L/R | 9-13 |
| ◆ 16 | L/R | 10-14 |
| ◆ 17 | L/R | 11-15 |
| ◆ 18 | L/R | 12-16 |
| ◆ 19 | L/R | 12-17 |
| ◆ 20 | L/R | 12-17 |

 **flexofold**
sailboat propellers



Step available from 1 to 1 in RH or LH.

Two-blades folding Sail Drive propeller

| 2 Blades | | |
|--------------------------|----------|---------|
| Ø Propeller Inches | Rotation | Step |
| ◆ 11,5 | L/R | 08-9,5" |
| ◆ 12,5 | L/R | 8 |
| ◆ 13 | L/R/LHS | 9 |
| ◆ 14 | L/R/LHS | 9,5 |
| ◆ 15 | L/R/LHS | 10-12 |
| ◆ 16,5 | L/R/LHS | 11-13 |
| ◆ 18 | L/R/LHS | 13-15 |

GORI PROPELLER
experience the difference



Three-blades folding Sail Drive propeller

| 3 Blades | | |
|--------------------------|-------------|-------|
| Ø Propeller Inches | Rotation | Step |
| ◆ 15 | L/R/LHS/RHS | 9-12 |
| ◆ 16,5 | L/R/LHS/RHS | 10-13 |
| ◆ 18 | L/R/LHS/RHS | 11-14 |
| ◆ 20 | L/R/LHS/RHS | 12-16 |
| ◆ 22 | L/R/LHS/RHS | 13-17 |
| ◆ 24 | L/R/LHS/RHS | 15-19 |
| ◆ 26 | L/R | 16-21 |
| ◆ 28 | L/R | 17-23 |
| ◆ 30 | L/R | 18-24 |

GORI PROPELLER
experience the difference



Shaft Lines "LS" with standard stern tub, stuffing box rigid

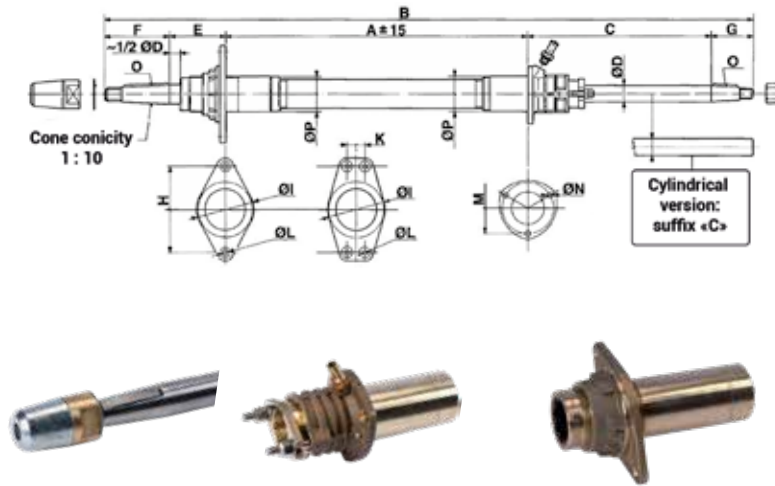

| Item | A | B | C | D | E | F | G | H | K | I | L | M | N | O | P |
|-----------|-----|------|-----|----|-----|-----|-----|-----|----|-----|------|-----|------|-------|----|
| ◆ LS25001 | 500 | 990 | 341 | 25 | 72 | 77 | 64 | 110 | - | 75 | 7 | 72 | 7 | 6x6 | 48 |
| ◆ LS30001 | 500 | 1055 | 370 | 30 | 85 | 103 | 68 | 125 | - | 85 | 7 | 80 | 7 | 8x7 | 54 |
| ◆ LS35001 | 600 | 1235 | 426 | 35 | 97 | 115 | 75 | 150 | - | 95 | 9 | 90 | 9 | 10x8 | 61 |
| ◆ LS40001 | 600 | 1315 | 480 | 40 | 110 | 130 | 78 | 165 | - | 110 | 10,5 | 108 | 10,5 | 12x8 | 68 |
| ◆ LS50001 | 600 | 1395 | 529 | 50 | 122 | 165 | 110 | 170 | 40 | 135 | 10,5 | 130 | 10,5 | 16x10 | 90 |
| ◆ LS60001 | 800 | 1655 | 550 | 60 | 125 | 180 | 115 | 175 | 40 | 140 | 10,5 | 135 | 10,5 | 18x10 | 96 |

Specify at the order the delivery in steel AISI 630 or 316.

Shaft Lines "LS" with floating stuffing box

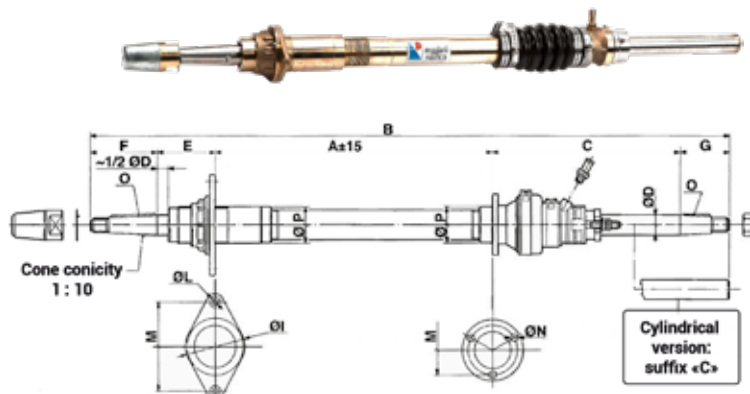

including stern head with flange

| Item | A | B | C | D | E | F | G | H | I | L | M | N | O | P |
|-----------|-----|------|-----|----|-----|-----|----|-----|-----|------|-----|------|------|----|
| ◆ LS25005 | 500 | 990 | 341 | 25 | 72 | 77 | 64 | 110 | 75 | 7 | 72 | 7 | 6x6 | 48 |
| ◆ LS30005 | 500 | 1055 | 370 | 30 | 85 | 103 | 68 | 125 | 85 | 7 | 80 | 7 | 8x7 | 54 |
| ◆ LS35005 | 600 | 1235 | 426 | 35 | 97 | 115 | 75 | 150 | 95 | 9 | 90 | 9 | 10x8 | 61 |
| ◆ LS40005 | 600 | 1315 | 480 | 40 | 110 | 130 | 78 | 165 | 110 | 10,5 | 108 | 10,5 | 12x8 | 68 |
| ◆ LS50005 | 600 | 1395 | 529 | 50 | 120 | 151 | 91 | 180 | 120 | 10,5 | 120 | 10,5 | 14x9 | 80 |

Specify at the order the delivery in steel AISI 630 or 316.

Propeller shaft cone 1:10 with zinc anode, key and washer



| Item | A | B | C | D | E |
|------------|------|-----|----|----|-------|
| ◆ 50200200 | 1500 | 77 | 22 | 25 | 6x6 |
| ◆ 50200300 | 1500 | 103 | 28 | 30 | 8x7 |
| ◆ 50200400 | 1500 | 115 | 30 | 35 | 10x8 |
| ◆ 50200700 | 2000 | 151 | 36 | 50 | 14x9 |
| ◆ 50200900 | 2000 | 195 | 50 | 60 | 18x10 |
| ◆ 50201100 | 2500 | 200 | 55 | 70 | 20x12 |

Specify at the order the delivery in steel AISI 630 or 316.

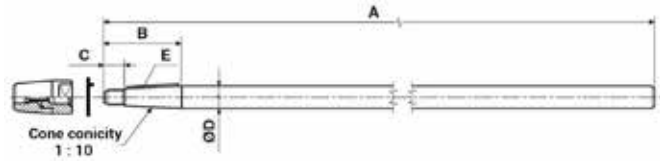

P - Bracket



| Item | A | B | C | D | E | F |
|------------|-----|-----|-----|----|-----|----|
| ◆ 55800100 | 400 | 115 | 100 | 25 | 180 | 25 |
| ◆ 55800200 | 400 | 115 | 120 | 30 | 180 | 25 |
| ◆ 55800300 | 450 | 130 | 140 | 35 | 190 | 35 |
| ◆ 55800400 | 450 | 130 | 160 | 40 | 190 | 35 |
| ◆ 55800500 | 550 | 160 | 180 | 45 | 220 | 40 |
| ◆ 55800600 | 550 | 160 | 200 | 50 | 220 | 40 |

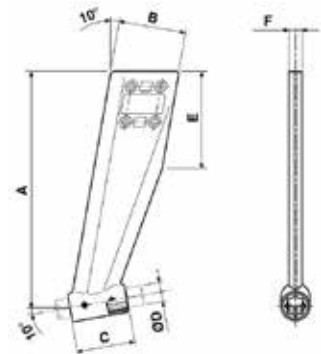

Propeller nut with zinc anode



| Item | Diameter |
|------------|----------|
| ◆ 54000200 | 25 |
| ◆ 54000300 | 30 |
| ◆ 54000400 | 35 |
| ◆ 54000500 | 40 |
| ◆ 54000600 | 45 |
| ◆ 54000700 | 50 |
| ◆ 54000800 | 55 |
| ◆ 54000900 | 60 |
| ◆ 54001000 | 65 |
| ◆ 54001100 | 70 |
| ◆ 54001200 | 75 |

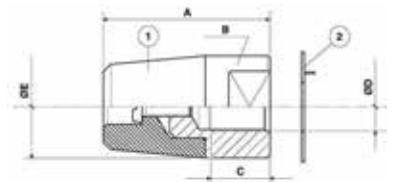

Brass and rubber - Bearings



| Item | D Ø in | L | E |
|------------|--------|----|-----|
| ◆ 30800600 | 25 | 35 | 100 |
| ◆ 30800800 | 30 | 40 | 120 |
| ◆ 30801000 | 35 | 48 | 140 |
| ◆ 30801200 | 40 | 56 | 160 |
| ◆ 30801600 | 50 | 66 | 200 |
| ◆ 30804900 | 60 | 78 | 240 |
| ◆ 30805300 | 70 | 90 | 280 |

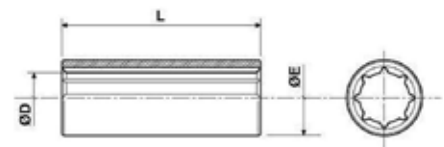

Shaft line zinc anodes - ring

| Item | Φ In mm | Φ Out mm | H mm |
|-------------|---------|----------|------|
| ◆ 505002022 | 19 | 65 | 18 |
| ◆ 505002023 | 25 | 55 | 25 |
| ◆ 505002024 | 30 | 65 | 18 |
| ◆ 505002025 | 35 | 55 | 25 |
| ◆ 505002026 | 40 | 80 | 20 |



Shaft line zinc anodes - spherical

| Item | Φ In mm | Φ Out mm | H mm |
|-------------|---------|----------|------|
| ◆ 505002017 | 20 | 58 | 56 |
| ◆ 505002018 | 25 | 58 | 56 |
| ◆ 505002019 | 30 | 58 | 56 |
| ◆ 505002020 | 35 | 65 | 66 |
| ◆ 505002021 | 40 | 81 | 77 |



RMTA stuffing box

| Ø In mm | Ø Out mm | Reference |
|---------|----------|------------|
| ◆ Ø 22 | 39 | QRM02239NI |
| ◆ Ø 25 | 42 | QRM02542NI |
| ◆ Ø 30 | 48 | QRM03048NI |
| ◆ Ø 35 | 54 | QRM03554NI |
| ◆ Ø 40 | 60 | QRM04060NI |



Non-banded pads with flange

| Ø In mm | Ø Out mm | Reference |
|---------|----------|-----------|
| ◆ Ø 25 | 40 | 48110080 |
| ◆ Ø 30 | 40 | 48110081 |
| ◆ Ø 35 | 54 | 48110082 |
| ◆ Ø 40 | 54 | 48110083 |

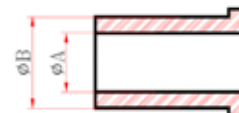

Half coupling

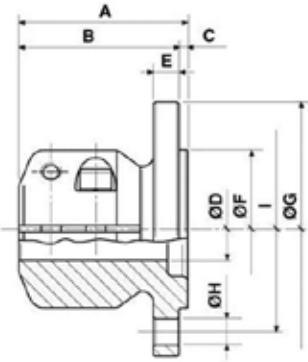
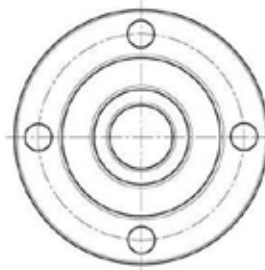

The Nanni half coupling are clamped to the propeller shaft for easy installation.

The flange on the gearbox side is made to the dimensions of most manufacturers in 4 inches (102 mm) or 5 inches (127 mm).

| Reference | A | B | C | D | E | F | G | H | K (I) |
|-------------|-----|-----|---|----|------|------|-----|------|-------|
| ◆ 810000120 | 68 | 65 | 3 | 22 | 10,5 | 63,5 | 102 | 10,5 | 82,5 |
| ◆ 505302107 | 68 | 65 | 3 | 25 | 10,5 | 63,5 | 102 | 10,5 | 82,5 |
| ◆ 810000121 | 68 | 65 | 3 | 30 | 10,5 | 63,5 | 102 | 10,5 | 82,5 |
| ◆ 810000122 | 68 | 65 | 3 | 30 | 11,5 | 63,5 | 127 | 11,5 | 108 |
| ◆ 810000123 | 120 | 117 | 3 | 35 | 11,5 | 63,5 | 102 | 10,5 | 82,5 |
| ◆ 810000114 | 93 | 90 | 3 | 35 | 11,5 | 63,5 | 127 | 11,5 | 108 |
| ◆ 810000124 | 120 | 117 | 3 | 40 | 11,5 | 63,5 | 102 | 10,5 | 82,5 |
| ◆ 95312199 | 93 | 90 | 3 | 40 | 11,5 | 63,5 | 127 | 11,5 | 108 |

Flexible coupling

| Intermittent service | Continuous service | Ø Shaft mm | Ø Out Inches | Ø Out mm | Length mm | Reference |
|----------------------|--------------------|------------|--------------|----------|-----------|-----------|
| ◆ 2.8 CH / 100T / MN | 2.4 CH / 100T / MN | 25 | 4 | 102 | 90 | 970307181 |
| ◆ 2.8 CH / 100T / MN | 2.4 CH / 100T / MN | 30 | 4 | 102 | 90 | 970307182 |
| ◆ 5.6 CH / 100T / MN | 4.8 CH / 100T / MN | 30 | 5 | 127 | 125 | 970307183 |
| ◆ 5.6 CH / 100T / MN | 4.8 CH / 100T / MN | 35 | 5 | 127 | 125 | 970307184 |
| ◆ 5.6 CH / 100T / MN | 4.8 CH / 100T / MN | 40 | 5 | 127 | 125 | 970307185 |

These couplings compensate for misalignment and improve the effects of torsional vibrations for a better comfort.

They are available in 2 sizes:

- 4 inches for propeller shaft from 25 to 30mm
- 5 inches for propeller shafts from 30 to 40mm

The clamping on the shaft is ensured by pinching.

The capacity is expressed in CH / 100T/MN propeller shaft.

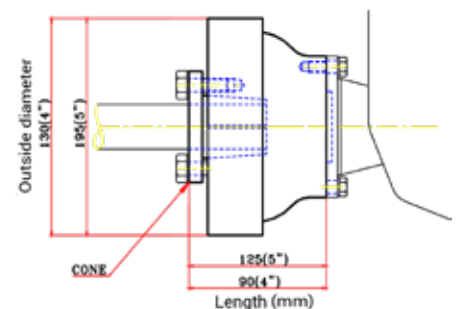

5 • SEA WATER CIRCUIT



Sea water intake accessories

Brass strainers

| Ø (inches) | Ø inner (mm) | Reference |
|------------|--------------|-----------|
| ◆ 3/8" | 12 | 655402089 |
| ◆ 1/2" | 15 | 655402088 |
| ◆ 3/4" | 19 | 655402083 |
| ◆ 1" | 25 | 655402076 |
| ◆ 1-1/4" | 34 | 655402082 |
| ◆ 1-1/2" | 40 | 925103289 |
| ◆ 2" | 49 | 925103292 |
| ◆ 2-1/2" | 63 | 925103293 |

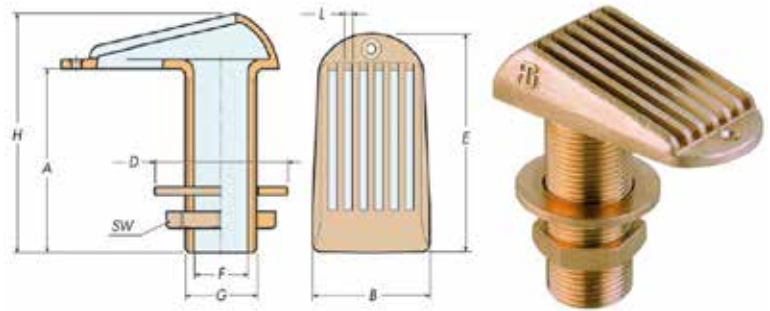

Bronze strainers

| Ø (inches) | Ø inner (mm) | Reference |
|------------|--------------|-----------|
| ◆ 1/2" | 11.5 | 655400155 |
| ◆ 3/4" | 15 | 655400156 |
| ◆ 1" | 25 | 655400157 |
| ◆ 1-1/4" | 33 | 655400158 |
| ◆ 1-1/2" | 38.5 | 655400159 |
| ◆ 2" | 49.5 | 655400160 |
| ◆ 2-1/2" | 64 | 655400161 |
| ◆ 3" | 77 | 655400162 |
| ◆ 4" | 101 | 655400163 |

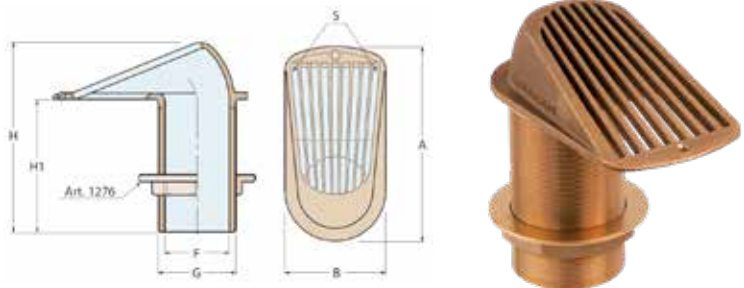

Brass grooved fittings

| Ø Int (inches) | Ø (mm) | Reference |
|----------------|--------|-----------|
| ◆ 1/4" | 8 | 925103408 |
| ◆ 1/4" | 10 | 925103322 |
| ◆ 3/8" | 12 | 925103225 |
| ◆ 1/2" | 13 | 925103470 |
| ◆ 1/2" | 15 | 925103320 |
| ◆ 3/8" | 15 | 925103471 |
| ◆ 3/4" | 20 | 48505174 |
| ◆ 1/2" | 20 | 925103321 |
| ◆ 1" | 25 | 655402075 |
| ◆ 3/4" | 25 | 925103291 |
| ◆ 1" | 30 | 925103469 |
| ◆ 1 1/4" | 32 | 655400141 |
| ◆ 1 1/4" | 35 | 925103319 |
| ◆ 1 1/4" | 38 | 970892603 |
| ◆ 1 1/2" | 40 | 925103317 |
| ◆ 1 1/2" | 45 | 925103318 |
| ◆ 2" | 50 | 925103323 |
| ◆ 2 1/2" | 63 | 925103324 |

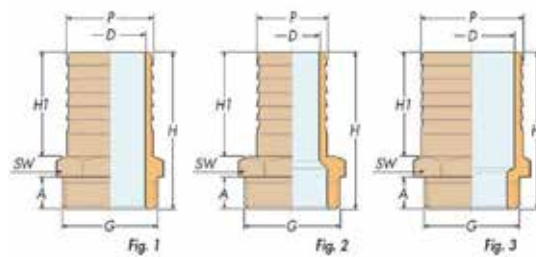

Bronze grooved fittings

| Ø Int (pouces) | Ø (mm) | Référence |
|----------------|--------|-----------|
| ◆ 1/4" | 10 | 48504029 |
| ◆ 3/8" | 10 | 48504030 |
| ◆ 1/2" | 13 | 48504031 |
| ◆ 1/2" | 14 | 48504032 |
| ◆ 3/8" | 15 | 48504033 |
| ◆ 3/4" | 20 | 48504034 |
| ◆ 1/2" | 20 | 48504035 |
| ◆ 1" | 25 | 48504036 |
| ◆ 3/4" | 25 | 48504037 |
| ◆ 1" | 30 | 48504038 |
| ◆ 1"1/4 | 32 | 48504039 |
| ◆ 1"1/4 | 35 | 48504040 |
| ◆ 1"1/4 | 38 | 48504041 |
| ◆ 1"1/2 | 40 | 48504042 |
| ◆ 1"1/2 | 45 | 48504043 |
| ◆ 2" | 50 | 48504044 |
| ◆ 2"1/2 | 63 | 48504045 |



Brass valves

| Ø (inches) | Reference |
|------------|-----------|
| ◆ 1/4" | 925103342 |
| ◆ 3/8" | 925103345 |
| ◆ 1/2" | 48504006 |
| ◆ 3/4" | 48504002 |
| ◆ 2" | 925103343 |

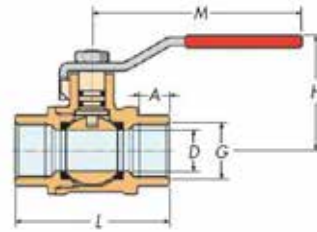

Bronze valves

| Ø Int (inches) | Reference |
|----------------|-----------|
| ◆ 3/8" | 48504020 |
| ◆ 1/2" | 48504021 |
| ◆ 3/4" | 48504022 |
| ◆ 1" | 48504023 |
| ◆ 1"1/4 | 48504024 |
| ◆ 1"1/2 | 48504025 |
| ◆ 2" | 48504026 |
| ◆ 2"1/2 | 48504027 |
| ◆ 3" | 48504028 |



Water strainers nickel plated bronze

Vertical aspiration with polycarbonate cover

| Ø (inches) | Flow (l/h) | Reference |
|------------|------------|------------|
| ◆ 1/2" | 1300 | QFI62012GI |
| ◆ 3/4" | 2500 | QFI62034GI |
| ◆ 1" | 3000 | QFI62001GI |
| ◆ 1-1/4" | 6000 | QFI62114GI |
| ◆ 1-1/2" | 7200 | QFI62112GI |
| ◆ 2" | 9500 | QFI62002GI |
| ◆ 2-1/2" | | QFI62212GI |
| ◆ 3" | 13500 | QFI62003GI |
| ◆ 4" | | QFI62004GI |

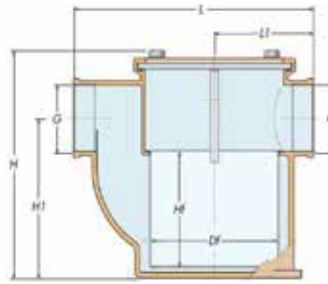

Horizontal aspiration with metal cover

| Ø (inches) | Flow (l/h) | Reference |
|------------|------------|------------|
| ◆ 2" | 3000 | QFI63001GI |
| ◆ 1-1/2" | 6000 | QFI62314GI |
| ◆ 2-1/2" | 7200 | QFI62312GI |
| ◆ 3" | 9500 | QFI63002GI |
| ◆ 1-1/4" | 13500 | QFI63212GI |
| ◆ 1" | 19500 | QFI63003GI |
| ◆ 4" | | QFI63004GI |

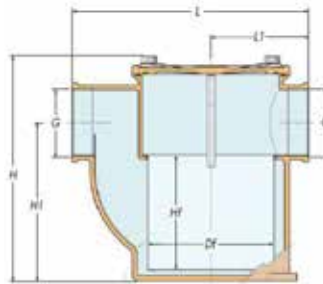

Vertical aspiration with polycarbonate cover

| Ø (inches) | Flow (l/h) | Reference |
|------------|------------|------------|
| ◆ 3/4" | 3000 | QFI64034GI |
| ◆ 1" | 5000 | QFI64001GI |
| ◆ 1-1/4" | 8000 | QFI64114GI |
| ◆ 1-1/2" | 12000 | QFI64114GI |
| ◆ 2" | 19000 | QFI64002GI |
| ◆ 3" | | QFI64003GI |
| ◆ 4" | | QFI64004GI |

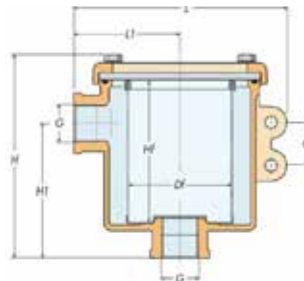

Accessories for water strainers

Stainless steel 316L basket

| Ø (inches) | Reference |
|------------|-----------|
| ◆ 1/2" | 655002001 |
| ◆ 1" | 655002002 |
| ◆ 1-1/4" | 655002003 |
| ◆ 1-1/2" | 655002004 |
| ◆ 2" | 655002005 |
| ◆ 2"1/2 | 655002006 |
| ◆ 3" | 655002007 |
| ◆ 4" | 655002008 |



Cover for water strainer

| Ø (inches) | Reference |
|---------------|-----------|
| ◆ 1" | 655500035 |
| ◆ 1-1/4" | 655500036 |
| ◆ 1-1/2" | 655500037 |
| ◆ 2" et 2"1/2 | 655500038 |
| ◆ 3 & 4" | 655500039 |

Seals for filters

For brass cover lid

| Ø (inches) | Reference |
|------------|------------|
| ◆ 1-1/2" | QOR00112GI |
| ◆ 2" | QOR00002GI |
| ◆ 3 & 4" | QOR03004GI |
| ◆ 3/4 & 1" | QOR03401GI |
| ◆ 1-1/4" | QOR00114GI |

For polycarbonate cover lid

| Ø (inches) | Reference |
|------------|------------|
| ◆ 1-1/4" | QDI62114GI |
| ◆ 1-1/2" | QDI62112GI |
| ◆ 1" | QDI62341GI |
| ◆ 2" | QDI62002GI |
| ◆ 3 & 4" | QDI62304GI |

Seawater accessories

Screw-on deck hatch

| Passing area Ø (mm) | ext Ø (mm) | Reference fitting |
|------------------------|---------------|----------------------|
| ◆ 80 | 130 | 925103371 |
| ◆ 115 | 173 | 925103369 |
| ◆ 150 | 230 | 925103370 |



Quick closing bronze valves PN16

| Ø (Inches) | Reference |
|------------|-----------|
| ◆ 3/8" | 925103353 |
| ◆ 1/2" | 925103349 |
| ◆ 3/4" | 925103352 |
| ◆ 1" | 925103346 |
| ◆ 1"-1/4 | 925103348 |
| ◆ 1"-1/2 | 925103347 |
| ◆ 2" | 925103350 |
| ◆ 1"-1/2 | 925103351 |



Round brass strainer

| Ø size (mm) | D1 | H | S (Cm ²) | Weight (gr) | Reference |
|-------------|-----|----|----------------------|-------------|-----------|
| ◆ 60 | 33 | 10 | 2,5 | 65 | 655500025 |
| ◆ 80 | 54 | 15 | 6 | 155 | 655500026 |
| ◆ 100 | 73 | 21 | 13 | 280 | 655500027 |
| ◆ 120 | 96 | 27 | 18 | 390 | 655500028 |
| ◆ 150 | 121 | 35 | 24 | 625 | 655500029 |

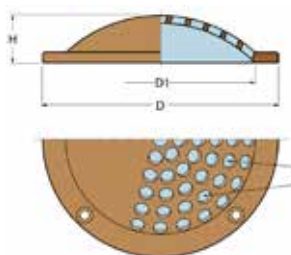

Milled brass strainer

| Ø size (mm) | D1 | H | S (Cm ²) | Weight (gr) | Reference |
|-------------|-----|----|----------------------|-------------|-----------|
| ◆ 60 | 33 | 10 | 2 | 70 | 655500030 |
| ◆ 80 | 54 | 15 | 6 | 145 | 655500031 |
| ◆ 100 | 73 | 21 | 11 | 285 | 655500032 |
| ◆ 120 | 96 | 27 | 23 | 380 | 655500033 |
| ◆ 150 | 121 | 35 | 36 | 550 | 655500034 |

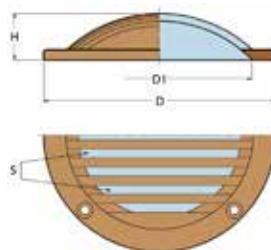

High resistance PVC pipe

Food grade reinforced with steel spiral to withstand liquids from -25°C to +65°C.

| Ø (mm) | Reference |
|--------|-----------|
| ◆ 16 | 32815004 |
| ◆ 20 | 32820003 |
| ◆ 25 | 32825003 |
| ◆ 32 | 32830001 |

| Ø (mm) | Reference |
|--------|-----------|
| ◆ 38 | 32838001 |
| ◆ 40 | 32840013 |
| ◆ 45 | 32845002 |
| ◆ 51 | 32850002 |



Plastic seawater filters

| Flow (l/min) | Ø Connections (mm) | Dimensions (mm) (*) * : 204 With In-Out | Reference |
|--------------|--------------------|--|------------|
| ◆ 150 | 19-25 | Ø = 150 ; H = 132 | QFI01925AP |
| ◆ 300 | 32-38 | Ø = 150 ; H = 132 | QFI03238AP |

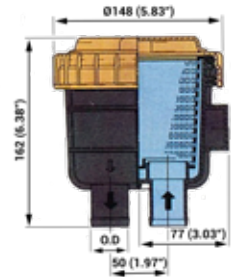

6 • ELECTRICITY



Battery cutters and insulators

The battery cut-off switches have been designed for use in pleasure and merchant marine. Their main function is to provide an effective means of disconnection between the battery and the starter; secondly, they provide protection against theft and the risk of short-circuiting, which can cause a fire.

The contact is locked in the closed position by turning the handle of the battery switch by a quarter turn. The battery switch will remain unaffected by any untimely activation that may be caused by vibrations. However, in the event of a failure such as a short circuit or to stop the boat in case of a problem with the control system, turning the handle in the opposite direction will open the circuits of the electrical harness.

This maneuver also prevents the batteries from being discharged if the boat is stopped for a long time.

Battery cutters



| Item | Rated voltage up to | Rated continuous current | Rated continuous current for 5 sec | Function et stockage mini | Operation & storage max | Weight | Binding posts | Poles | Reference |
|------|---------------------|--------------------------|------------------------------------|---------------------------|-------------------------|--------|---------------|-------|-----------|
| ◆ 1 | 48 V | 150 A | 1000 A | -40°C | +85°C | 240 g | | 1 | 48200176 |
| ◆ 2 | 48 V | 150 A | 1000 A | -40°C | +85°C | 240 g | M10 | 1 | 48201009 |

Batteries coupling

Rugged construction.
12V - 32V DC. 150A continuous (300A peak).
Built-in alternator protection.

Ref : 925104207



Batteries insulator

Single pole, high resistance plastic, with removable key.
500A maximum.

Ref : 925104204



7 • PUMPS



Submersible pumps

Standard bilge pump

Bilge pump with integrated float switch and 19 mm connection hose.

Dimensions : 151 x 80 x 104 mm.

| Voltage supply | Ø (mm) | Flow (l/min) | Reference |
|----------------|--------|--------------|-----------|
| ◆ 12 V/1,8 A | 19 | 32 | 48101186 |
| ◆ 12 V/3 A | 19 | 48 | 48101186 |
| ◆ 12 V/4 A | 19 | 75 | 48101187 |
| ◆ 24 V/2,5 A | 19 | 75 | 48101188 |



High performance bilge pump

Heavy duty bilge pump with check valve. Equipped with 316 stainless steel shaft and double ball bearing motor with mechanical seal.

ISO 8848 Marine EN 55014.

Dimensions : 151 x 80 x 104 mm.

| Voltage supply | Ø (mm) | Flow (l/min) | Reference |
|----------------|--------|--------------|-----------|
| ◆ 12 V/7,5 A | 32-38 | 110 | 48101189 |
| ◆ 24 V/4 A | 32-38 | 110 | 48101190 |
| ◆ 12 V/9 A | 32-38 | 135 | 48101191 |
| ◆ 24 V/4,5 A | 32-38 | 135 | 48101192 |



Bilge pump Mini - Midi - Maxi

Allpa Mini, Midi, Maxi bilge pump with 316 steel shaft. Salt water resistant, high impact plastic housing.

| Voltage supply | Ø (mm) | Flow (l/min) | Reference |
|----------------|--------|--------------|-----------|
| ◆ 12 V/1,8 A | 19 | 27 | 48101193 |
| ◆ 24 V/3A | 24 | 50 | 48101194 |
| ◆ 12 V/4A | 29 | 75 | 48101195 |



Oil drain pumps

The F3B-19 oil drain pump has a rubber impeller pump with a built-in quick-reversing valve. The pump is designed to drain oil from the engine; with its built-in reverser, the direction of flow can be changed to pump new oil into the engine.

3/8" threaded ports.

Dimensions 170 x 113 x 115 mm (L x l x h).

Capacity : 12l/min.



| Voltage supply | Ø (Inches) | Flow (l/min) | Reference |
|----------------|---------------|-----------------|-----------|
| ◆ 12 V | 3/8" | 12 | 970316683 |
| ◆ 24 V | 3/8" | 12 | 970317108 |

Spare parts Oil Drain pumps

| Item | Reference |
|---------------|-----------|
| ◆ Impeller | 48101196 |
| ◆ Seal | 48101197 |
| ◆ Lid | 48101198 |
| ◆ O-Ring | 48101199 |
| ◆ Screw | 48101200 |
| ◆ Nut | 48101201 |
| ◆ Ring | 48101202 |
| ◆ Service kit | 48101206 |

8 • MAINTENANCE



NANNI Service Kit allows a follow-up of the maintenance of the NANNI engines by gathering all the necessary under a single reference.

NANNI offers Service Kit 250 hours / 1 year, including the oil and diesel filter, as well as the sea water pump impeller kit, zinc anode.

Service kit 1 year / 250 hours

| ENGINE | Reference |
|------------------------------|-----------|
| ◆ N2.10 | 860025001 |
| ◆ N2.14- N3.21-2.50HE-3.75HE | 860025002 |
| ◆ N3.30 - N4.38 | 860025003 |
| ◆ N4.40 - 4.195HE | 860025004 |
| ◆ N4.50 - 4.220HE | 860025005 |
| ◆ N4.65 - N4.80 | 860025006 |
| ◆ N4.115 - N4.140 | 860025007 |

Includes: oil filter, diesel filter, impeller, pump seal and zinc anode.



Impeller kit

| ENGINE | Reference |
|--|-----------|
| ◆ N2.10 - N2.14 - N3.21 | 860020001 |
| ◆ N3.30- N4.38-N4.40 | 860020002 |
| ◆ N4.50 | 860020003 |
| ◆ N4.65 - N4.80 | 860020004 |
| ◆ N4.115 - N4.140 | 860020005 |
| ◆ T4.270 - 230 - 205 / 4.390 - 4.380TDI T4.155 / T4.200 / 6.420 | 860020008 |

Includes: impeller, pump gasket.

| ITEM | Reference |
|-------------|------------|
| ◆ Anode Kit | 970494635P |

Includes: zinc anode with seal.

nanni

NANNI INDUSTRIES S.A.S.

11, Avenue Abbé Mariotte

33260 La Teste de Buch

France

Tel +33 (0)5 56 22 30 60

www.nannienergy.com

NANNI SRL

Via degli Olmetti,44/A

00060 Formello - Roma

Italia

Tel +39 06 30 88 42 51

www.nannienergy.com

